

vtech[®]
Baby

User's Manual

Toot-Toot Animals

Chicken Coop



© 2015 VTech
Printed in China
91-002993-002^(K)

VTech understands that a child's needs and abilities change as they grow and with that in mind we develop our toys to teach and entertain at just the right level...

vtech Baby

Toys that will stimulate their interest in different textures, sounds and colours

I am...

...responding to colours, sounds and textures

...understanding cause and effect

...learning to touch, reach, grasp, sit-up, crawl and toddle

Birth-36 months

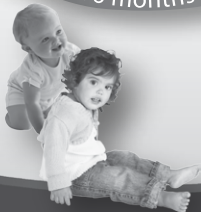

Pre-School

Interactive toys to develop their imagination and encourage language development

I want...

...to get ready for school by starting to learn the alphabet and counting

...my learning to be as fun, easy and exciting as can be

...to show my creativity with drawing and music so my whole brain develops

3-6 years



Electronic Learning Computers

Cool, aspirational and inspiring computers for curriculum related learning

I need...

...challenging activities that can keep pace with my growing mind

...intelligent technology that adapts to my level of learning

...National Curriculum based content to support what I'm learning at school

4-10 years



To learn more about this and other VTech® products, visit www.vtech.co.uk

INTRODUCTION

Thank you for purchasing the **VTech® Toot-Toot Animals Chicken Coop!**

Explore the **Toot-Toot Animals Chicken Coop** by **VTech®**. Learn about animals, colours and more with the **SmartPoint®** chicken. Launch the chicken and rocking chick down the slide. For added fun, you can connect this play set to other **Toot-Toot Animals** and **Toot-Toot Drivers®** play sets (each sold separately). Please note SmartPoint responses may vary.

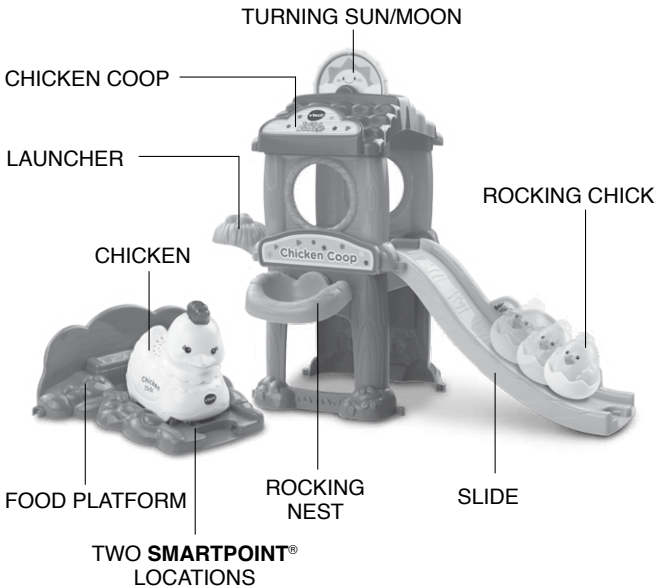

INCLUDED IN THIS PACKAGE

- One user's manual
- One sheet of labels
- One **VTech® Toot-Toot Animals** chicken
- One chicken coop roof with turning sun/moon
- Two chicken coop top supports
- One chicken coop bottom left support with one rocking nest



- One chicken coop bottom right support
- One **SmartPoint®** launcher
- One launcher base
- One slide

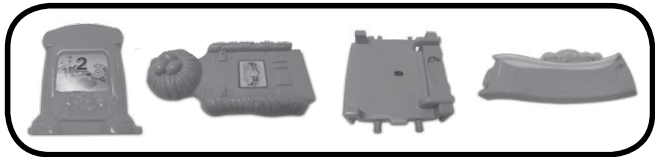

- One **SmartPoint®** food platform
- One rocking chick



WARNING: All packing materials, such as tape, plastic sheets, packaging locks and tags are not part of this toy, and should be discarded for your child's safety.

NOTE: Please keep user's manual as it contains important information.

Unlock the packaging locks:

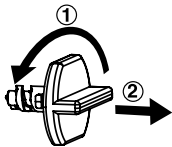

① Turn the packaging lock counter-clockwise several times.

② Pull out and discard the packaging lock.

GETTING STARTED

BATTERY INSTALLATION - Chicken

1. Make sure the unit is turned **OFF**.
2. Locate the battery cover on the bottom of the chicken. Use a coin or a screwdriver to loosen the screw.
3. Install 2 new AAA (AM-4/LR03) batteries following the diagram inside the battery box. (The use of new alkaline batteries is recommended for maximum performance.)
4. Replace the battery cover and tighten the screw to secure the battery cover.

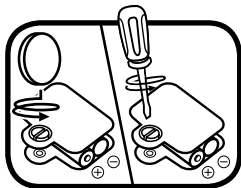

BATTERY NOTICE

- Use new alkaline batteries for maximum performance.
- Use only batteries of the same or equivalent type as recommended.
- Do not mix different types of batteries: alkaline, standard (carbon-zinc) or rechargeable (Ni-Cd, Ni-MH), or new and used batteries.
- Do not use damaged batteries.
- Insert batteries with the correct polarity.
- Do not short-circuit the battery terminals.
- Remove exhausted batteries from the toy.
- Remove batteries during long periods of non-use.
- Do not dispose of batteries in fire.
- Do not charge non-rechargeable batteries.
- Remove rechargeable batteries from the toy before charging (if removable).
- Rechargeable batteries are only to be charged under adult supervision.

Disposal of batteries and product



The crossed-out wheellie bin symbols on products and batteries, or on their respective packaging, indicates they must not be disposed of in domestic waste as they contain substances that can be damaging to the environment and human health.



The chemical symbols Hg, Cd or Pb, where marked, indicate that the battery contains more than the specified value of mercury (Hg), cadmium (Cd) or lead (Pb) set out in Battery Directive (2006/66/EC).

The solid bar indicates that the product was placed on the market after 13th August, 2005.

Help protect the environment by disposing of your product or batteries responsibly.

For more information, please visit:

www.recycle-more.co.uk

www.recyclenow.com

Please stick the labels to the play set securely as indicated below:

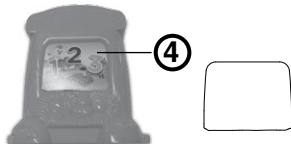
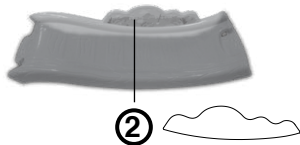
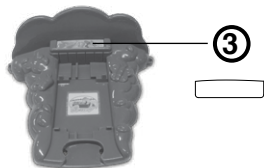
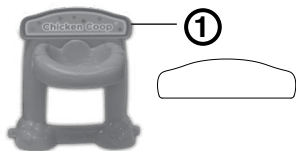
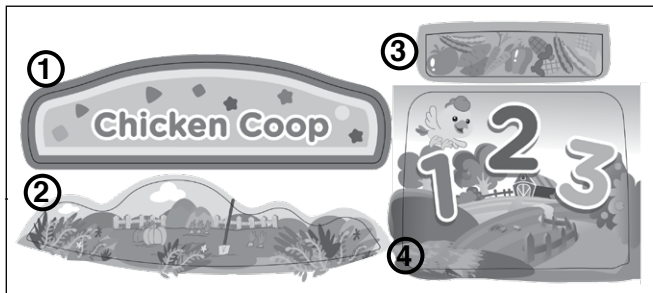

ASSEMBLY INSTRUCTIONS

With the **VTech® Toot-Toot Animals Chicken Coop**, safety comes first. To ensure your child's safety, adult assembly is required.

1. Attach the **SmartPoint®** launcher to the launcher base as shown. You will hear a “click” sound to indicate the launcher is secure.
2. Attach the launcher base to the chicken coop bottom left and right supports. Once the launcher base is connected to the chicken coop bottom supports, it cannot be detached.
3. Insert the two chicken coop top supports into the roof.
4. Place the chicken coop on top of the launcher.

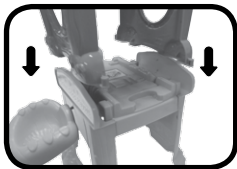
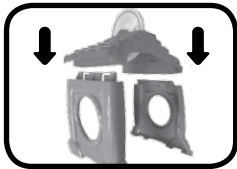
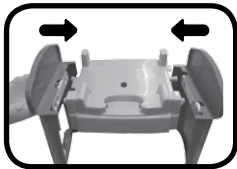

5. Attach the slide to the launcher. You will hear a “click” sound to indicate the slide is secure.

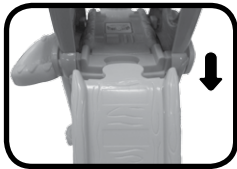

6. Attach the **SmartPoint®** food platform to the left or right supports as shown.

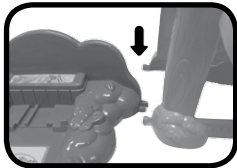

PRODUCT FEATURES - CHICKEN

1. ON/OFF SWITCH

To turn the unit **ON**, slide the **ON/OFF SWITCH** to the **ON** (⏻) position. To turn the unit **OFF**, slide the **ON/OFF SWITCH** to the **OFF** (●) position.

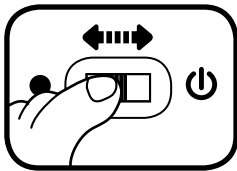

2. AUTOMATIC SHUT-OFF

To preserve battery life, the **VTech® Toot-Toot Animals** chicken will automatically power-down after approximately 30 seconds without input. The unit can only be turned on again by pressing the light-up button or pushing the chicken quickly.

ACTIVITIES - CHICKEN

1. Slide the **ON/OFF SWITCH** to the **ON** position to turn the unit on. You will hear a chicken sound, a song and a phrase. The light will flash with the sounds.
2. Press the **LIGHT-UP BUTTON** to hear fun sounds, sing-along songs and phrases. The light will flash with the sounds.
3. Push the chicken to hear fun sounds and melodies. While a melody is playing, push the chicken again to add in fun sounds on top of the melody. The light will flash with the sounds.
4. For added fun, the chicken interacts with **VTech® Toot-Toot Animals** play sets (each sold separately). Simply roll the chicken over one of the play set's **SmartPoint®** locations to see the light flash and to hear greetings, fun sounds, short tunes and sing-along songs. You can also play with your animal on **Toot-Toot Drivers®** play sets (each sold separately). Please note SmartPoint responses may vary.

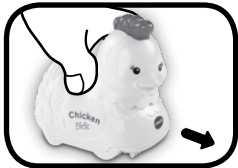
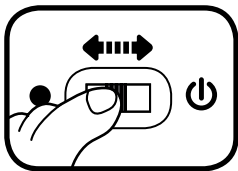

PRODUCT FEATURES – CHICKEN COOP

1. Move the chicken or any **SmartPoint®** animal (each sold separately) over the chicken coop's two **SmartPoint®** locations to trigger fun sounds, songs, or phrases.
2. Place the chicken on the **LAUNCHER** inside the chicken coop. Lift up the **LAUNCHER** to send the chicken down the slide.
3. Place the chicken on the **SmartPoint®** food platform to trigger a fun response.
4. Place the rocking chick inside the rocking nest.



5. Turn the sun/moon for day and night play.



CARE & MAINTENANCE

1. Keep the unit clean by wiping it with a slightly damp cloth.
2. Keep the unit out of direct sunlight and away from any direct heat.
3. Remove the batteries when the unit will not be in use for an extended period of time.
4. Do not drop the unit on hard surfaces and do not expose the unit to moisture or water.

TROUBLESHOOTING

If for some reason the program/activity stops working or malfunctions, please follow these steps:

1. Please turn the unit **OFF**.
2. Interrupt the power supply by removing the batteries.
3. Let the unit stand for a few minutes, then replace the batteries.
4. Turn the unit **ON**. The unit should now be ready to play again.
5. If the product still does not work, replace with a new set of batteries.

If the problem persists, please call our Consumer Services Department on 01235 546810 (from UK) or +44 1235 546810 (outside UK) and a service representative will be happy to help you.

IMPORTANT NOTE:

Creating and developing VTech® products is accompanied by a responsibility that we take very seriously. We make every effort to ensure the accuracy of the information, which forms the value of our products. However, errors sometimes can occur. It is important for you to know that we stand behind our products and encourage you to call our Consumer Services Department on 01235 546810 (from UK) or +44 1235 546810 (outside UK), with any problems and/or suggestions that you might have. A service representative will be happy to help you.

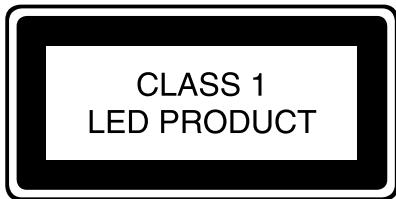



PRODUCT WARRANTY



Thank you for choosing this quality product from VTech. We hope it will bring many hours of entertainment, imaginative play and learning.

1. The product detailed above is covered by a one year warranty from the date of purchase, against any defects in materials or workmanship.
2. The product may be returned to the place of purchase. Alternatively the product can be returned to VTech Electronics Europe plc (see address below), with proof of purchase, without proof of purchase no replacement will be provided.
3. VTech Electronics Europe plc will examine the product and if it is found to be defective due to faulty materials or workmanship, will replace the product at their discretion.
4. If the product covered by this warranty is damaged due to misuse, modification or unauthorised repair, or because of faulty batteries, battery discharge or incorrect electrical connections, then this warranty becomes void.
5. This warranty is personal to the original purchaser and is not transferable.
6. Breakages to the LCD screen are not covered by the warranty.
7. Returns to VTech Electronics Europe plc should include a cheque or postal order for £1.50 towards the cost of return postage and packaging.
8. Products returned to VTech Electronics Europe plc, should be addressed as follows and packed carefully to avoid damage in transit (Please do not include batteries or adaptor).
Please include details of the fault together with your name and address.

VTech Electronics Europe plc, c/o Tablogix Limited, 200 Milton Park, Abingdon, Oxon OX14 4TA

THIS WARRANTY IS OFFERED AS AN EXTRA BENEFIT AND DOES NOT AFFECT CONSUMERS' STATUTORY RIGHTS.

This warranty is valid for the UK and Eire only. For products purchased outside the UK and Eire, please contact your local distributor or place of purchase.

